

SPECIFICATION

1. Rating : DC 30V, 0.5A ;
2. Contact resistance : $\leq 30m\Omega$;
3. Insulation resistance : $\geq 100M\Omega$;
4. Withstand voltage : 500VAC ;
5. Insertion and extraction force : 3-20N;
6. life test : 5,000 cycles °

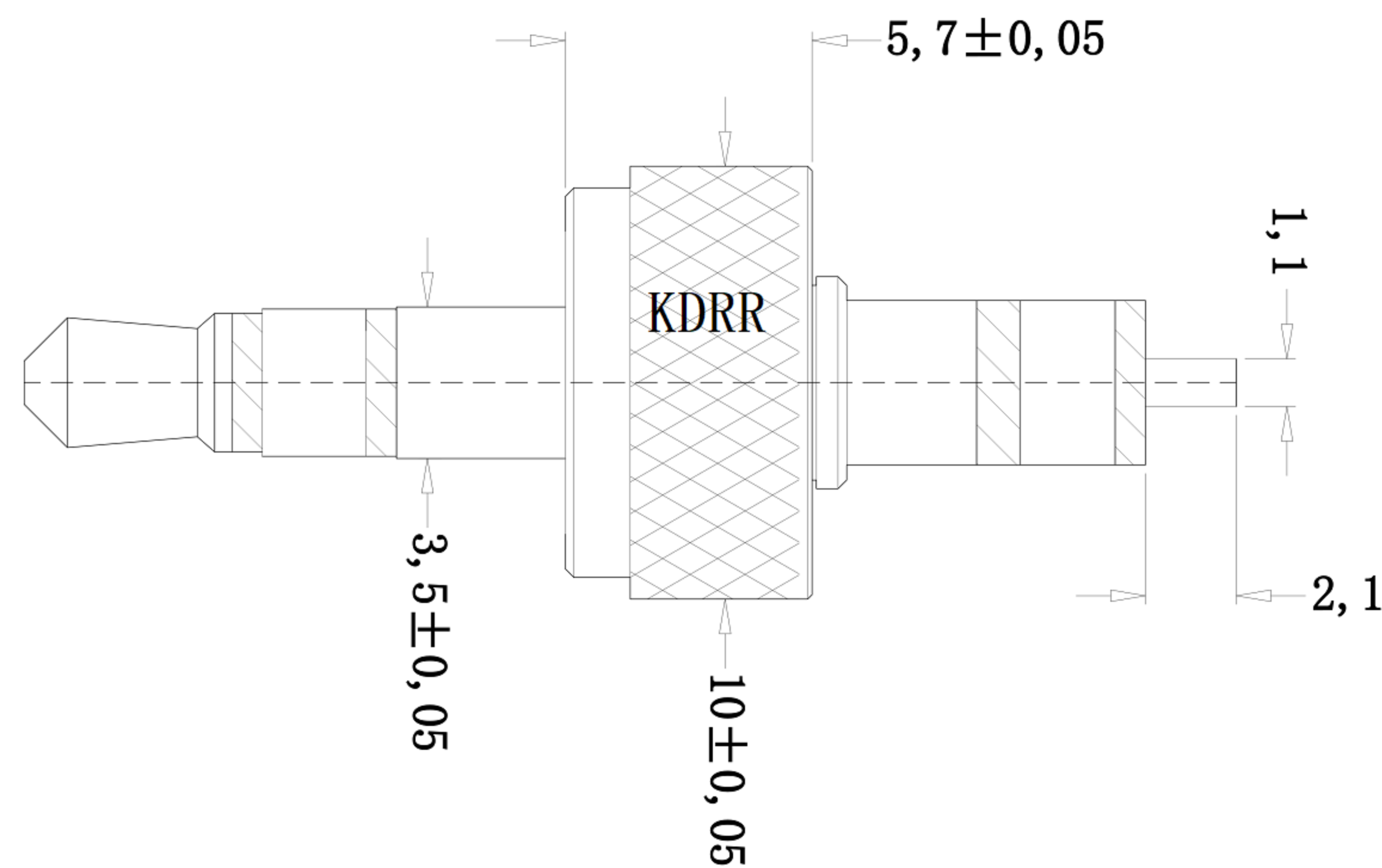

Technology Request:

1. Outlook: No burr, no hurt.
2. Electronic performance:
 - a: Insulation resistance: Above DC500V/100M Ω ;
 - b: Endure voltage: AC500V at 1 minute;
 - c: Contact resistance: Under 30m Ω ;
3. Insertion force & withdrawal force: 0.3-3kgf.
4. Salt spray test: 24H.
5. Meet RoHS.
6. Remark * is important specification.



东莞市高迪电子有限公司
Dong Guan KDRR Electronic Switch Jack Co., Ltd.

TOLERANCE UNLESS OTHERWISE STATED :
 Up to 5 ± 0.2
 Above 5 ~ 15 ± 0.3
 Above 15 ~ 30 ± 0.4
 Above 30 ~ 50 ± 0.5
 Angle $\pm 0.3^\circ$

3RD. ANGEL'S UNITS MM

DRAWN BY:	DATE	MAT'L	TITLE	Plug
Jack Lu	06/19/17			
CHECKED BY:	DATE	FINISH	MODLE	Audio Plug
Jacky Chen	06/19/17			
APPROVED BY:	DATE	SCALE	DWG NO.	GD-PJT-B-3503-M
Tony Kao	06/19/17	1 : 1	PART NO.	
SHEET NO.			1 of 1	

ITEM NO.	DESCRIPTION	DRAWN	DATE